

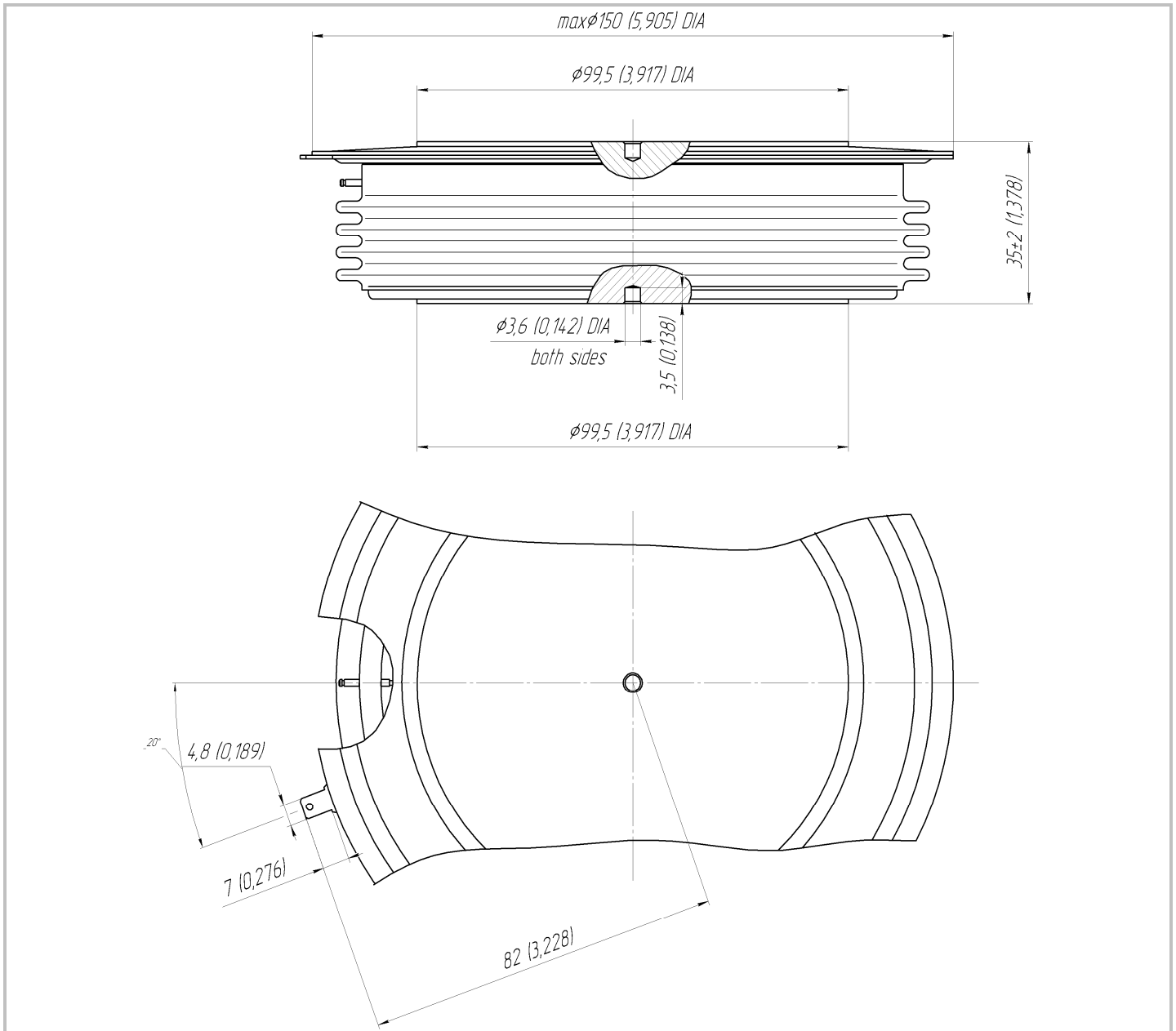

Package Type **T.G3**

Mounting Force **70.0 ÷ 90.0 kN**

Nominal Weight **2700 g**



D_s 62.16 (2.447)

The surface creepage distance is defined as the shortest path along the ceramic surface between the anode flange and the gate contact

D_a 26.00 (1.024)

The air distance is defined as the shortest direct path between the anode flange and gate contact