

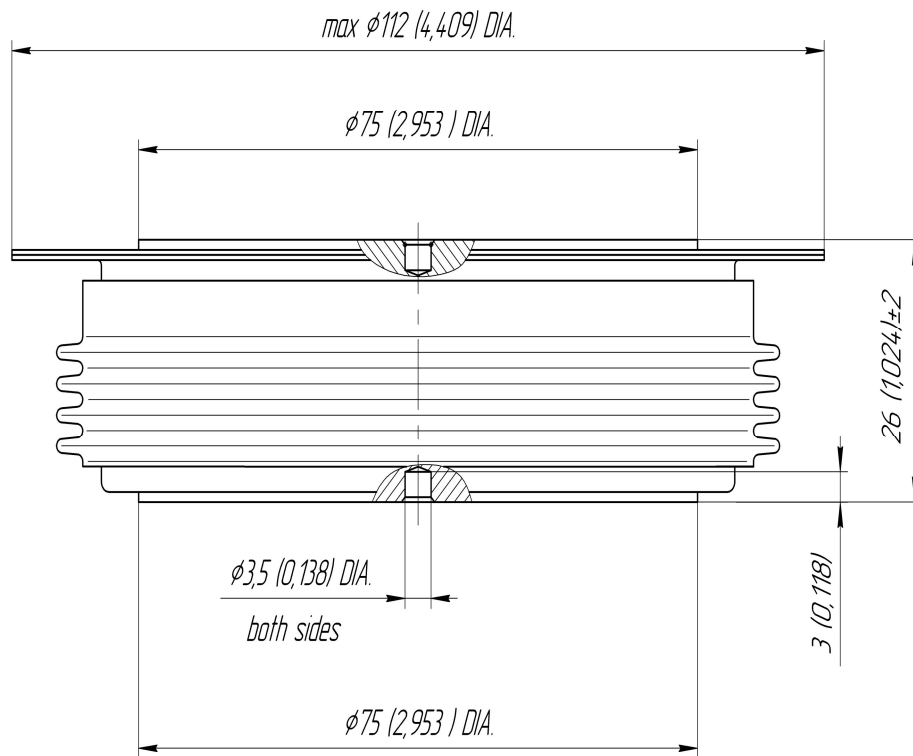

Package Type **D.F1**

Mounting Force **40.0 ÷ 50.0 kN**

Nominal Weight **1500 g**



D_s 41.4 (1.630)

The surface creepage distance is defined as the shortest path along the ceramic surface between the anode and cathode flanges

D_a 23.1 (0.909)

The air distance is defined as the shortest direct path between the anode and cathode flanges